

# the Providence

2757 Square feet

## LOWER LEVEL 2757 Square feet



- 1 Large double garage.
- 2 Guest suite with shower and romantic soaking tub.
- 3 Private guest terrace with access to landscape.
- 4 Large in house storage.

This plan is for marketing purposes only, and is subject to change. All images are artist's renditions only.

## MAIN LEVEL & GARAGE 2757 Square feet



- 1 Large double garage.
- 2 Grand entry with tiled floors and in-floor heating.
- 3 Master suite with steam shower and soaking tub open to bedroom.
- 4 Luxurious granite vanities and private water closets.
- 5 Private master terrace.

This plan is for marketing purposes only, and is subject to change. All images are artist's renditions only.

## SECOND LEVEL: OPTION A 2757 Square feet



This plan is for marketing purposes only, and is subject to change. All images are artist's renditions only.

## SECOND LEVEL: OPTION B 2757 Square feet



This plan is for marketing purposes only, and is subject to change. All images are artist's renditions only.

- 9A Two story living space with terrace overlooking lakeside.
- 10A Grand rundlestone and gas fireplace.
- 11A Gourmet kitchen with state of the art appliances, fixturing and materials.
- 12A Dining for up to 14 people.
- 13A Large laundry and storage area.
- 14A Engineered wood flooring with in-floor comfort heating throughout main level

- 9B Two story living space
- 10B Grand rundlestone
- 11B Gourmet cooking island with abundant storage and granite counter tops.
- 12B Dining for up to 10 people.
- 13B Convenient laundry area.
- 14B Engineered wood flooring with in-floor comfort heating throughout main level
- 15B Additional gas fireplace with cozy reading area.
- 16B Additional full-height pantry and storage.

## LOFT 2757 Square feet

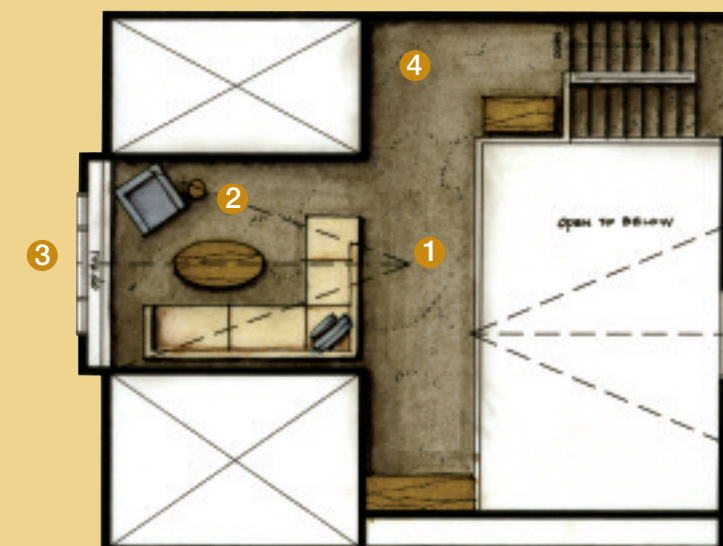

This plan is for marketing purposes only, and is subject to change. All images are artist's renditions only.

- 1 Spacious loft/media room overlooking two-story living space.
- 2 Area can be option as an office or guest area.
- 3 Luscious views towards forests.
- 4 High quality carpeting in private areas and bedrooms.